



# ONVO

ONVO in Healthcare

[onvouk.com/healthcare](http://onvouk.com/healthcare)



<b>Introduction</b>	<b>04 - 05</b>
<b>Full Height Cliniwash</b>	<b>06 - 09</b>
<b>Half Height Cliniwash</b>	<b>10 - 13</b>
<b>Recessed Cliniwash</b>	<b>14 - 17</b>
<b>Corner Cliniwash</b>	<b>18 - 21</b>
<b>Modular IPS Unit</b>	<b>22 - 23</b>
<b>Scrubwash</b>	<b>24 - 25</b>
<b>Case Studies</b>	<b>26 - 45</b>

ONVO are leading the way in raising the hygiene bar around clinical hand washing points in public healthcare buildings.

**Here are the key features that set our basin apart from the traditional IPS and basin set-up:**

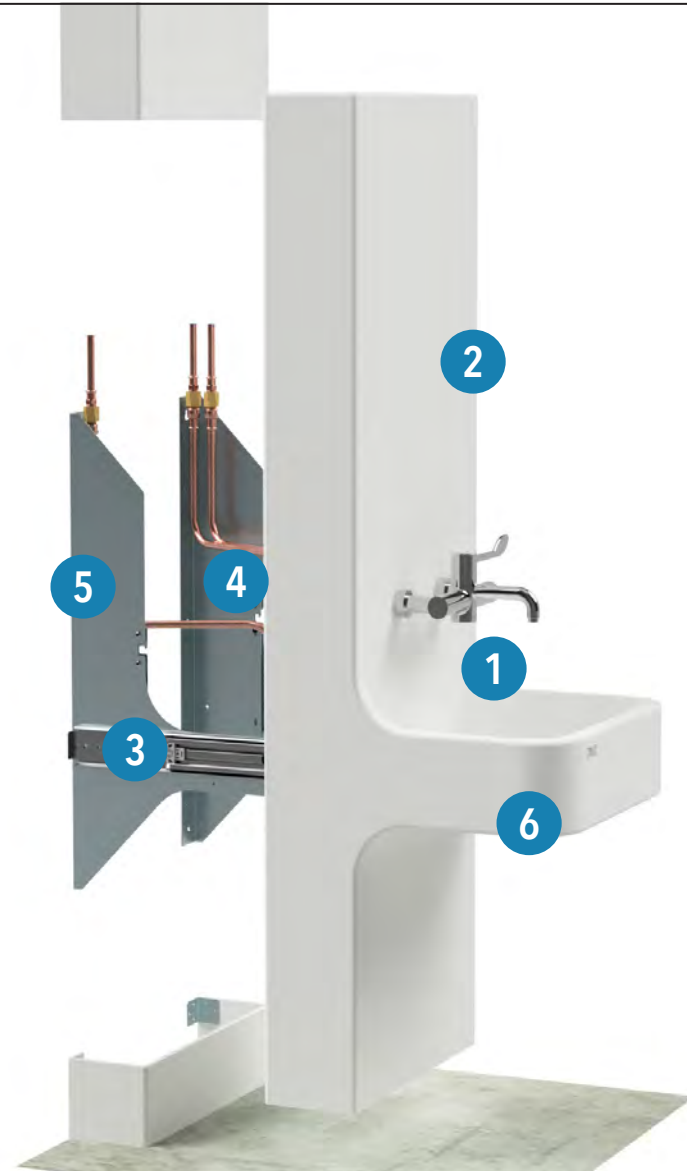

- 1 Formed in one piece**  
The Cliniwash clinical hand wash basin is a completely seamless IPS and basin solution. This includes where the basin is joined to the IPS which means there is no silicone joint around the basin to harbour bacteria and also peel away over time.
- 2 No access panels or doors**  
Access panels and doors are not required, removing the difficult to clean bacteria traps that normally surround these areas. This also overcomes panels chipping and misaligning.
- 3 ONVO rail system**  
Allows the entire IPS and clinical hand wash basin to slide effortlessly forward from the wall to provide full access to the pipework behind.
- 4 ONVO pre-plumbed copper swivel system**  
Complies with the demand for copper piping in healthcare environments whilst remaining flexible to enable the unit to slide forward and offer easy access. This pre-plumbed set-up also brings the hot water return to within 270mm of the back of the tap to meet regulations.
- 5 ONVO zinc plated steel support frame**  
Provides robust support and won't deteriorate over time. Also designed in such a way as not to clash with any pipework running down the face of the wall.
- 6 ONVO magnetic locking system**  
Seamless, tamper proof and sleek locking system meaning there are no dirt traps as with a traditional lock.

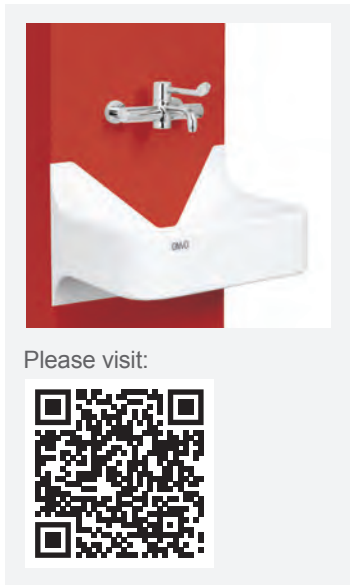

Please visit:



The ONVO Full Height Cliniwash is a floor to ceiling all in one IPS and Clinical basin solution. This is for situations where the pipework is coming from the ceiling down the face of the wall and requires concealing. All different ceiling heights can be catered for by adjusting the height of the ceiling plinth and the floor plinth is optional depending on the particular waste detail.

Product Codes:

Code	Width	Height	Depth
600C/FH	600mm	2.4-3.0m	605mm
500C/FH	500mm	2.4-3.0m	482mm

Tap not included, please specify separately.

Available Colours:



Orange



Sky  
Blue



Light  
Green



Fiery  
Red



Banana



Grey



White

Other colours options are available upon request.

### Technical Drawing: 600mm Wide

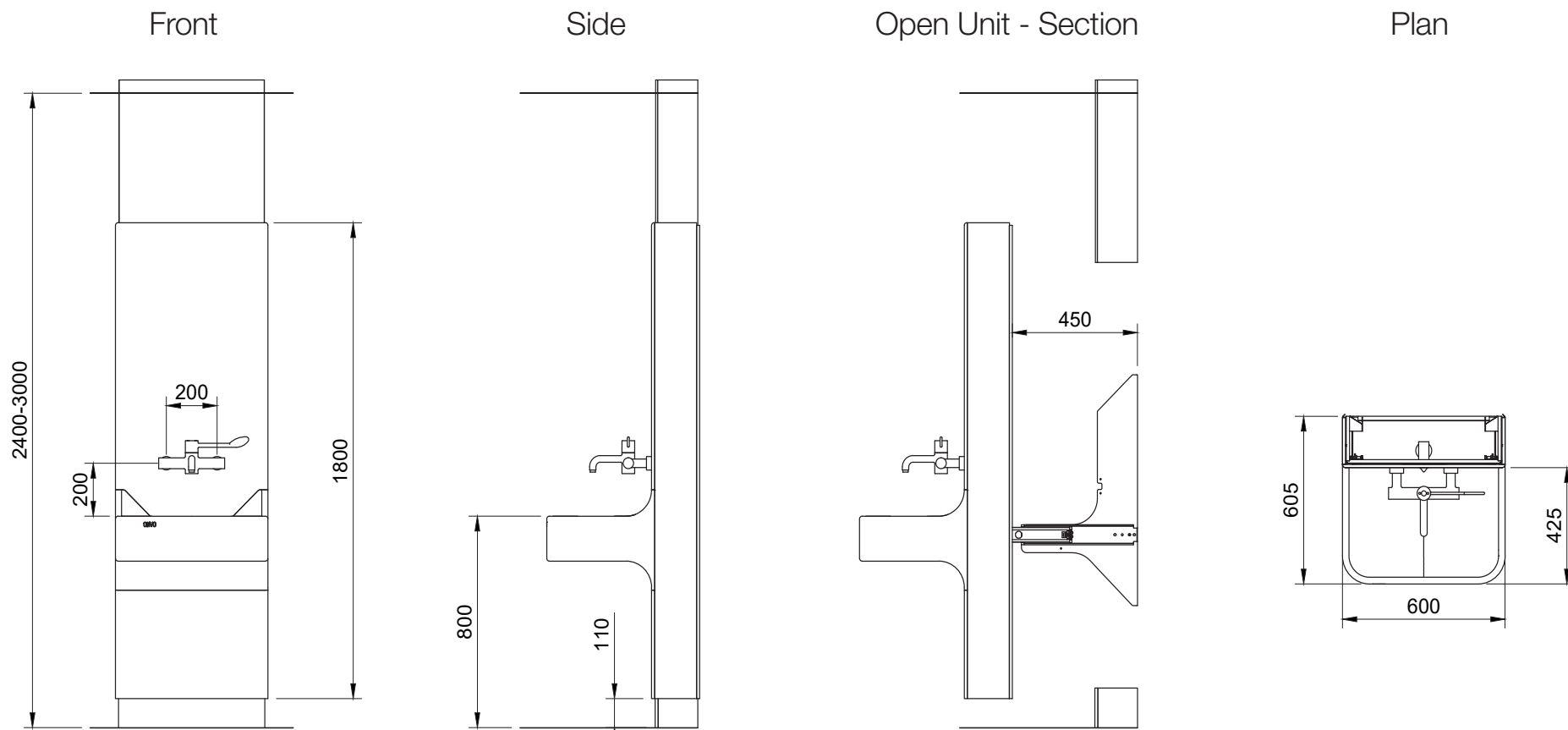

Technical Drawing: 500mm Wide

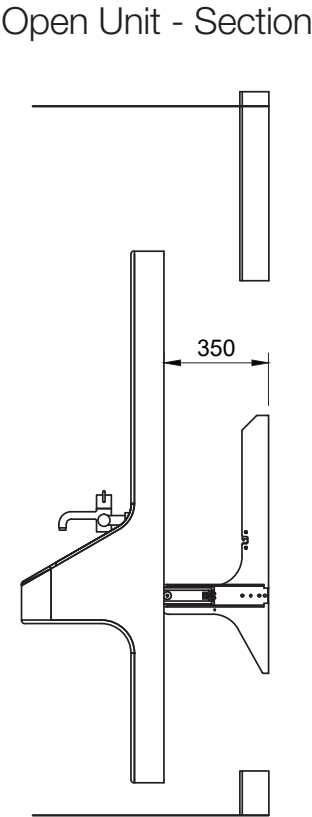
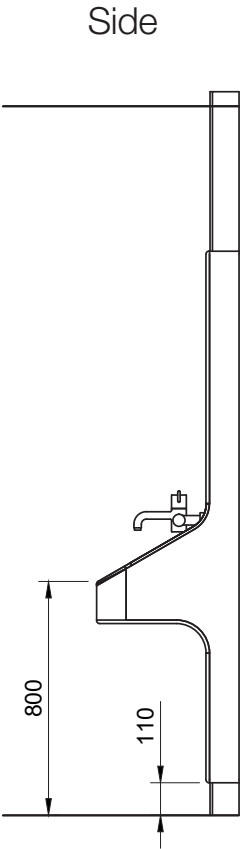
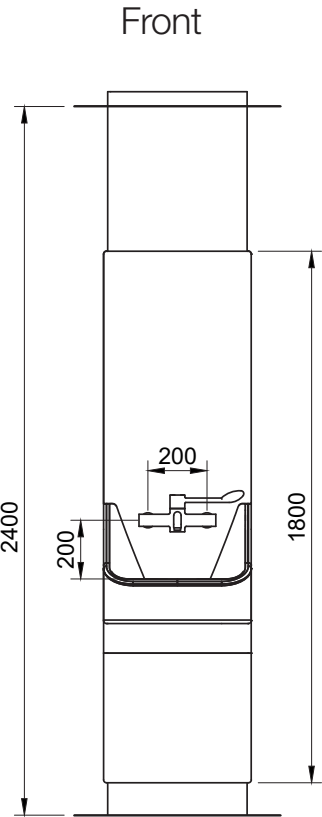

# ONVO

---

## Full Height Cliniwash





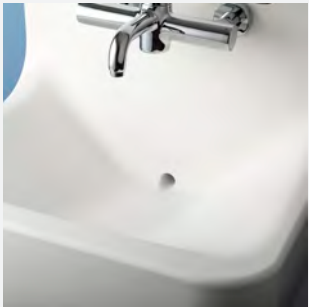

Please visit:



“

### Product Codes:

Code	Width	Height	Depth
600C/HH	600mm	1800m	605mm
500C/HH	500mm	1800m	482mm

Tap not included, please specify separately.

### Available Colours:



Orange



Sky  
Blue



Light  
Green



Fiery  
Red



Banana



Grey



White

Other colours options are available upon request.

### Technical Drawing: 600mm Wide

Front

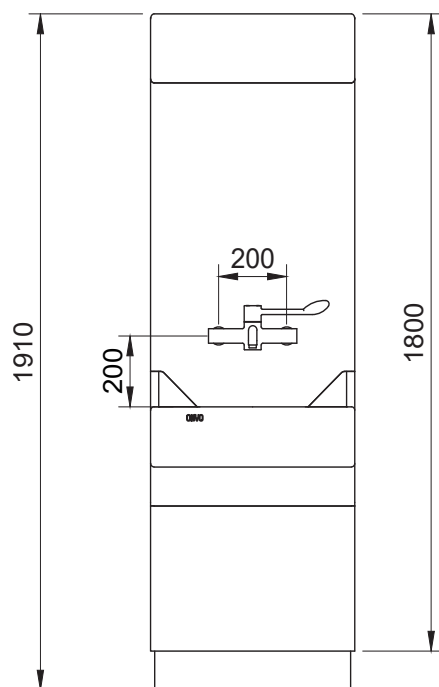

Side

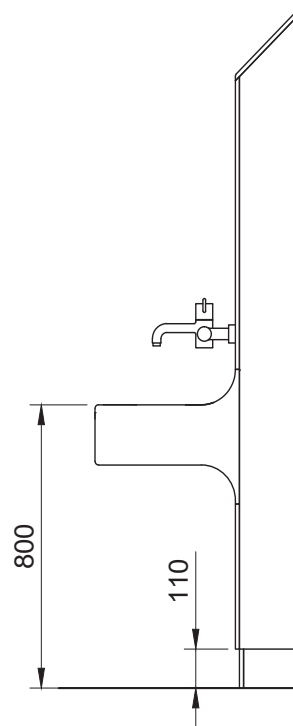

Open Unit - Section

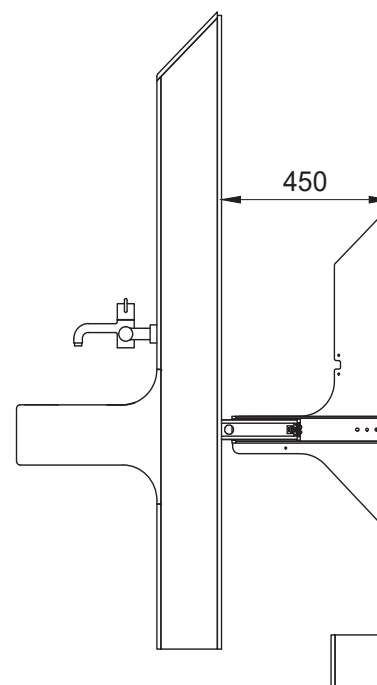

Plan

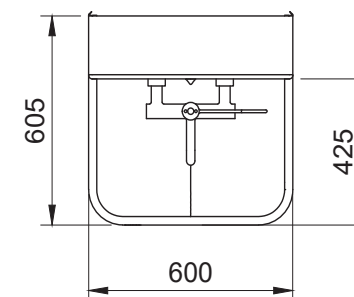

Technical Drawing: 500mm Wide

Front

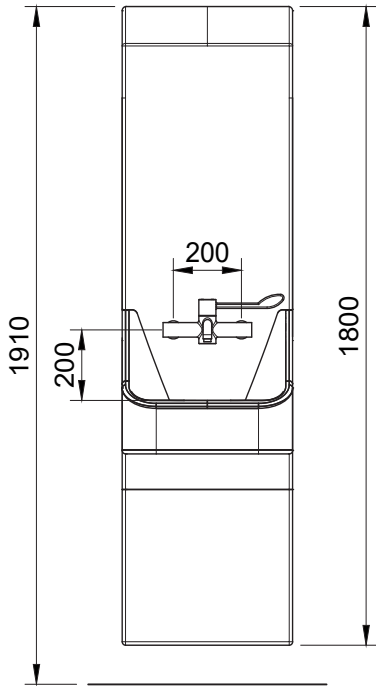

Side

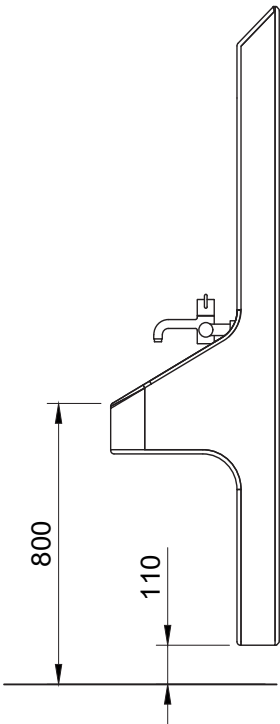

Open Unit - Section

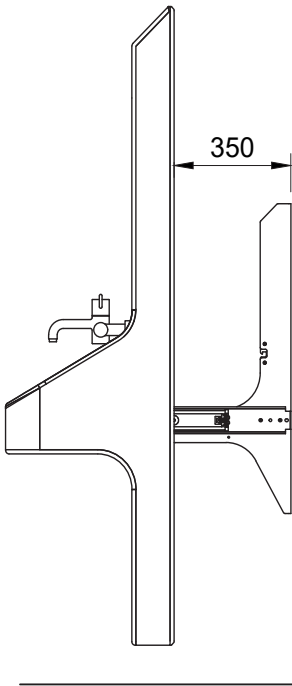

Plan

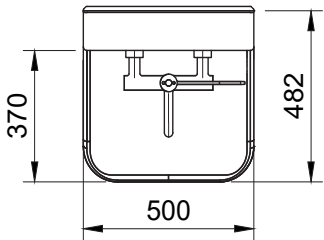

# ONVO

---

## Half Height Cliniwash





Please visit:



The ONVO Recessed Cliniwash is a fully recessed all in one IPS and Clinical basin solution. This is for situations where there is a wall void of minimum 100mm to accommodate the pipework, waste pipe and steel support frame for the unit. Projecting less than 450mm in total from the finished wall this product is ideal for rooms where space is limited.

### Product Codes:

Code	Width	Height	Depth
600C/R	600mm	1800m	437mm
500C/R	500mm	1800m	400mm

Tap not included, please specify separately.

### Available Colours:



Orange



Sky  
Blue



Light  
Green



Fiery  
Red



Banana



Grey



White

Other colours options are available upon request.

## Technical Drawing: 600mm Wide

Front

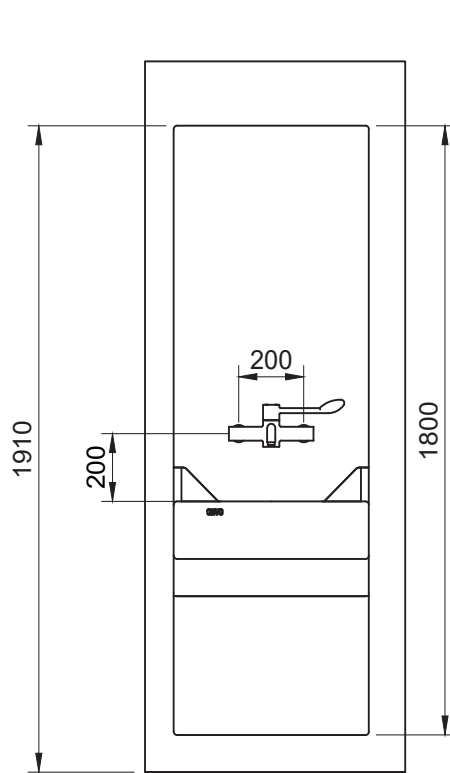

Side

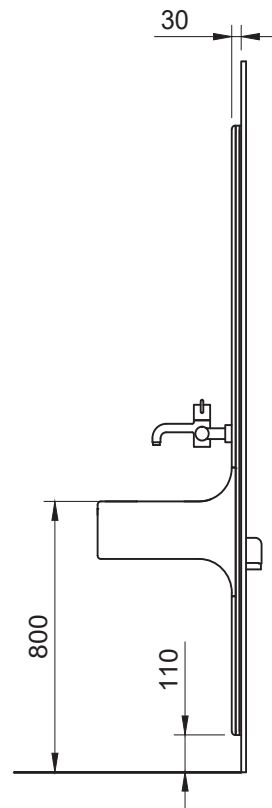

Open Unit - Section

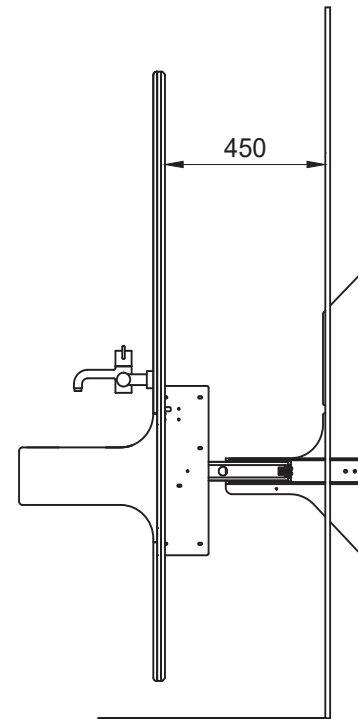

Plan

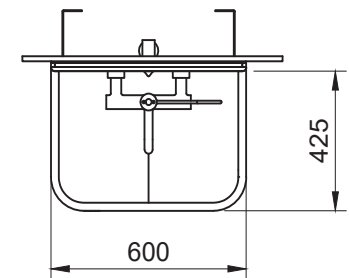

## Technical Drawing: 500mm Wide

Front

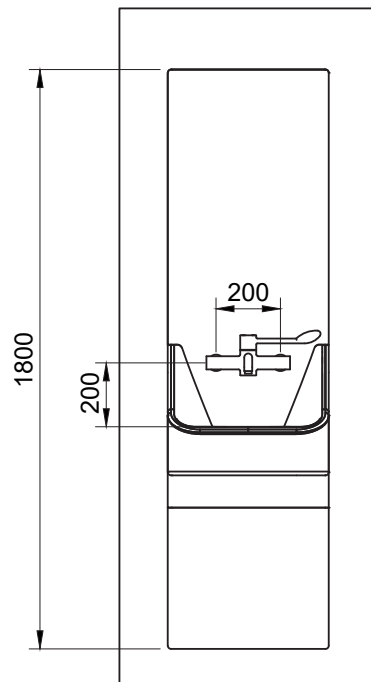

Side

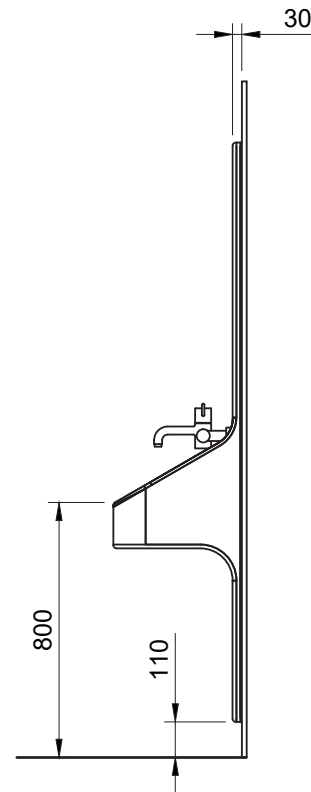

Open Unit - Section

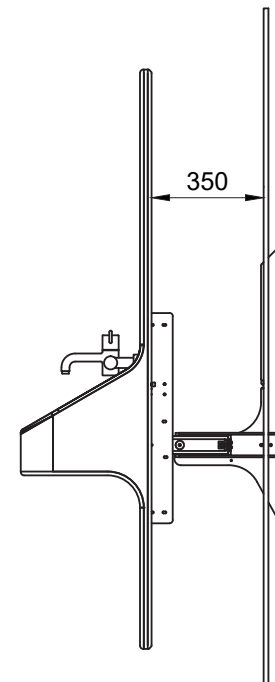

Plan

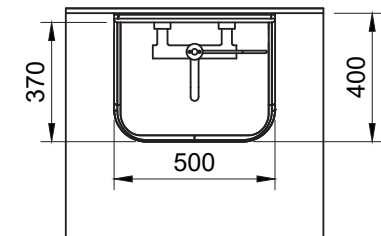









Please visit:



The ONVO Corner Cliniwash is an all-in-one IPS and Clinical basin solution for situations where the basin and IPS are located in the corner of a room or ward. This offers a full height IPS solution from the side of the basin to the corner of the room giving concealed space to run pipework, waste pipes and other services down the corner of room. The side piece can be handed right or left depending on the situation.

### Product Codes:

Code	Width	Height	Depth
600C/FHC	750mm	2.4-3.0m	605mm

Tap not included, please specify separately.

### Available Colours:



Orange



Sky  
Blue



Light  
Green



Fiery  
Red



Banana



Grey



White

Other colours options are available upon request.

## Technical Drawing: Right Hand Corner

Front

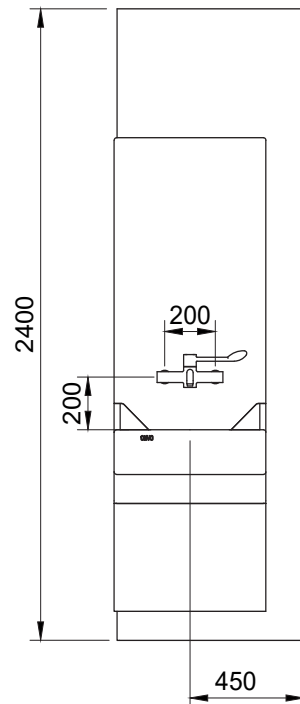

Side

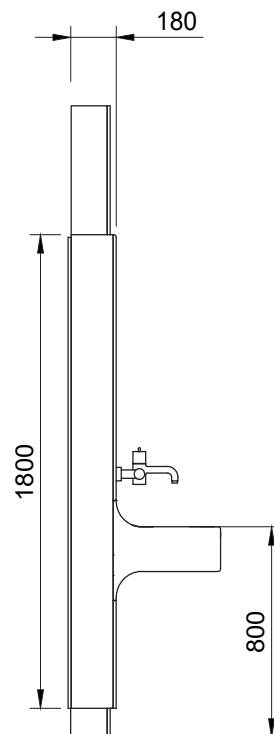

Open Unit - Section

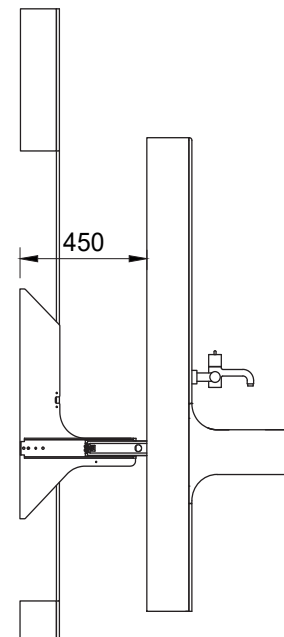

Plan

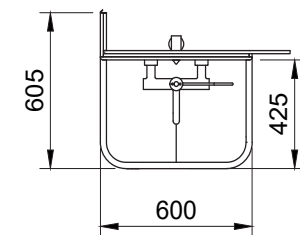

Technical Drawing: Left Hand Corner

Front

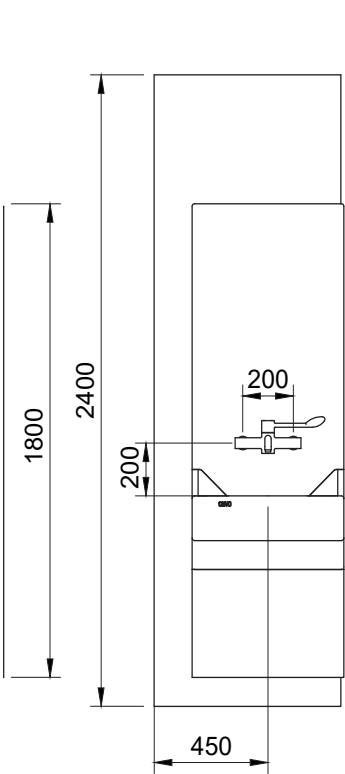

Side

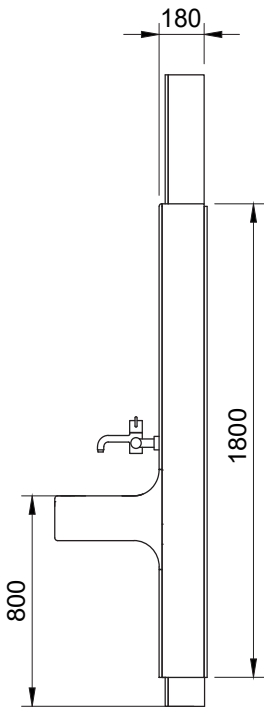

Open Unit - Section

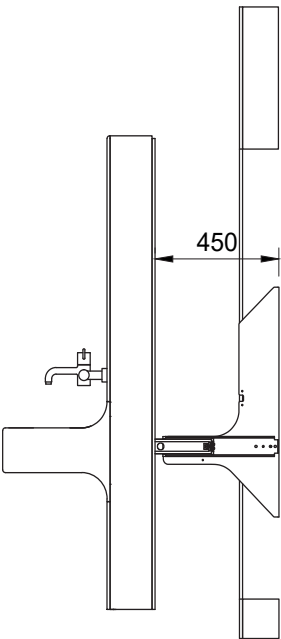

Plan

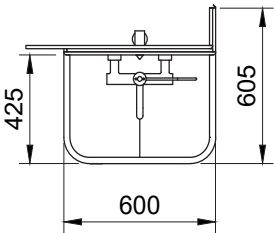

# ONVO

---

Corner Cliniwash





The ONVO Modular IPS Unit is a solid surface IPS solution for disabled toilet areas and En-suites and has been designed so that the IPS in these areas matches in with the rest of the ONVO product range. This system is very quick and easy to install and available in the same colour range as the ONVO basins. The basin used can either be the ONVO Recessed Cliniwash or any other basin is also compatible. All toilets and grab rails are also compatible with this solution.

Product Codes:

Code	Length	Height	Depth	ONVO Basin
MIPSU/B	1485mm (Basin Wall) x 950mm (Toilet Wall)	2.4m - 3.0m	180mm	With Basin
MIPSU	1485mm (Basin Wall) x 950mm (Toilet Wall)	2.4m - 3.0m	180mm	Without Basin

Either side of the IPS can be extended if required.  
The toilet and basin walls are interchangeable.  
WC and Grab Rails are not included but can be at additional cost.  
Tap not included, please specify separately.

Available Colours:



Orange



Sky  
Blue



Light  
Green



Fiery  
Red



Banana



Grey



White

Other colours options are available upon request.

## Technical Drawing

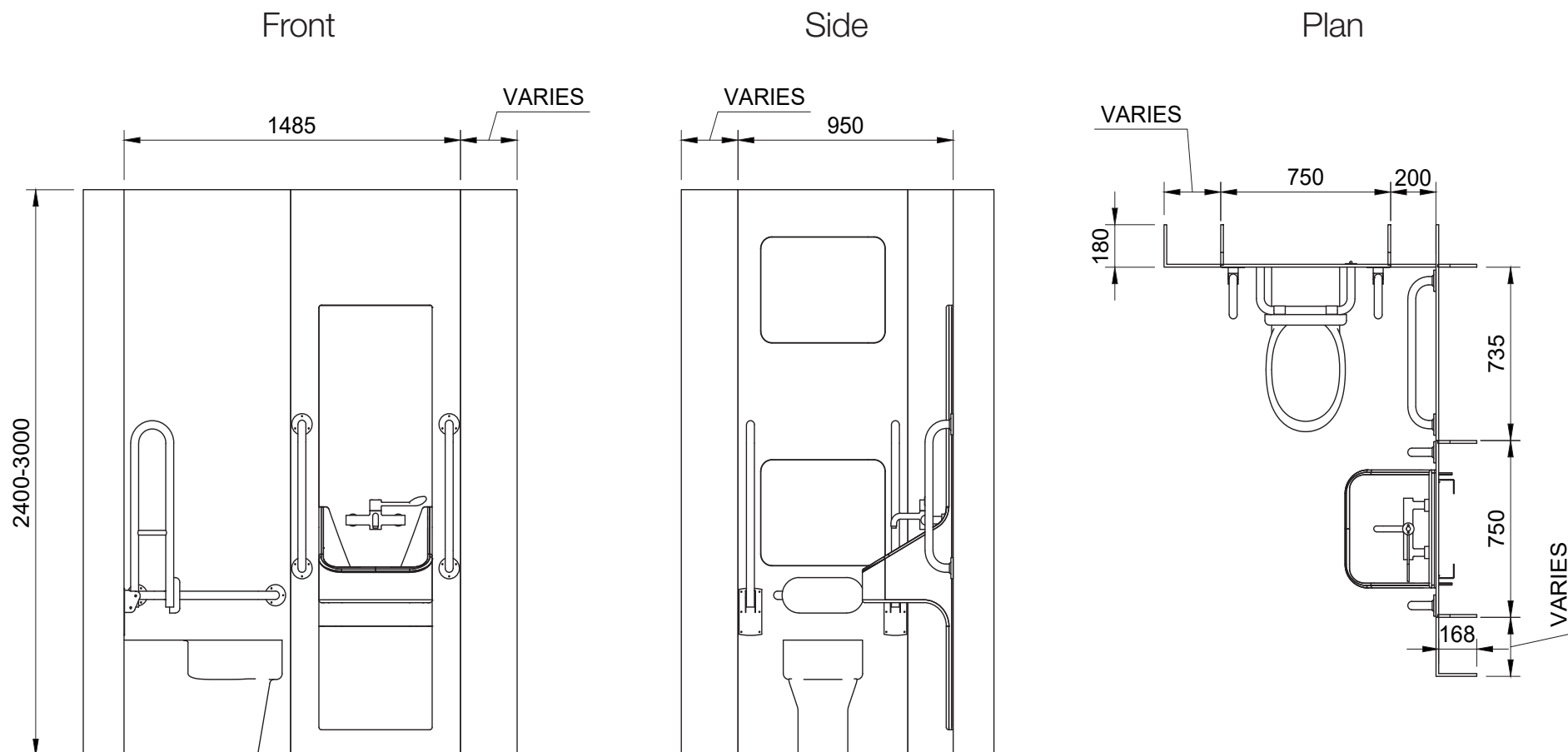



The ONVO Scrubwash is a surgical scrub sink for operating scrub areas. Manufactured from solid surface which is a very hygienic and seamless material the Scrubwash is has no dirt traps and is easy to keep clean. It is available in a number of different lengths for the amount of users required. A void is required in the wall behind the unit for the wall mounted taps and waste.

**Product Codes:**

Code	Length	Depth	Users
802SW	800mm	400mm	1
1602SW	1600mm	400mm	2
2402SW	2400mm	400mm	3

**Available Colours:**



Pearl



White

## Technical Drawing: 800mm Wide

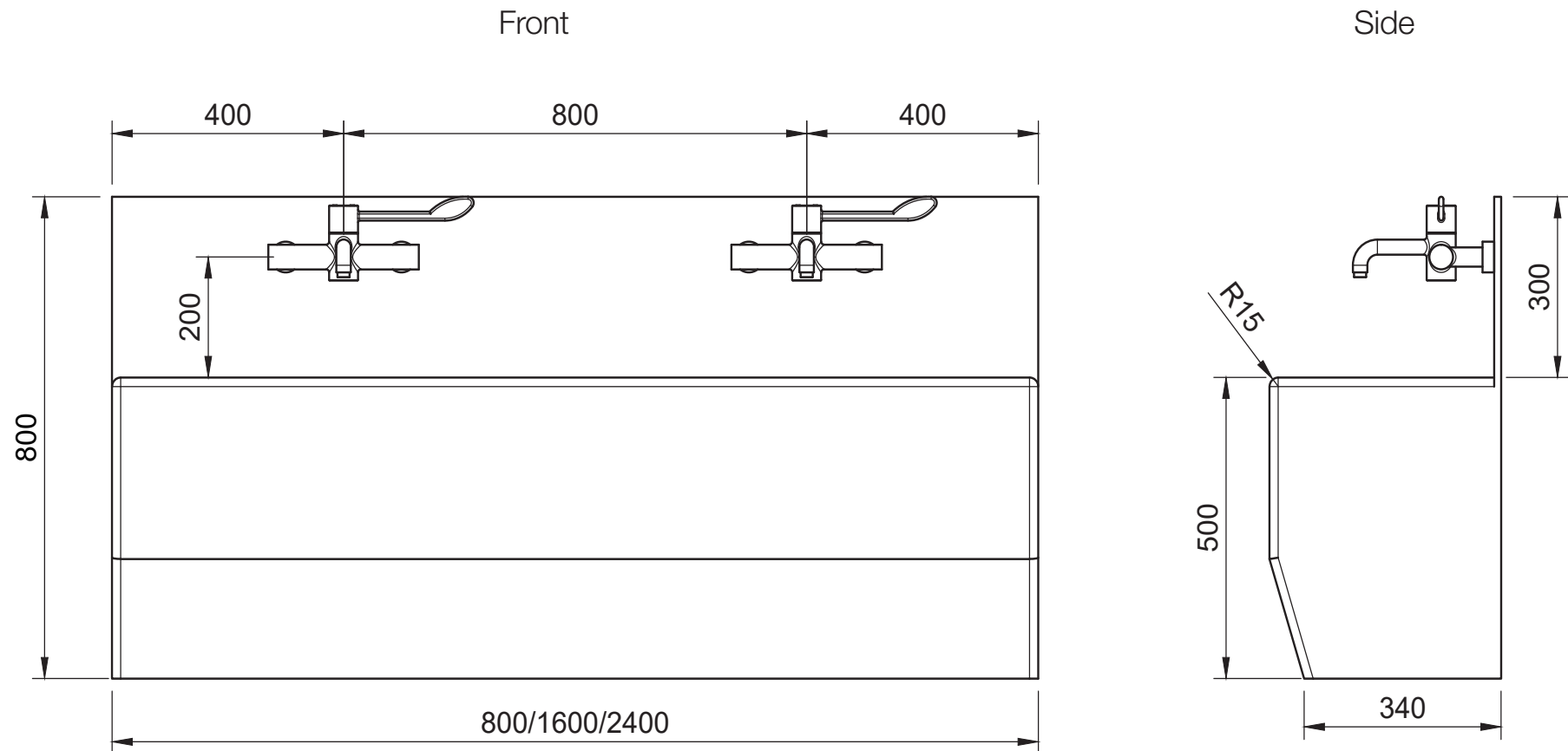



Full Height Cliniwash

Client – West Hertfordshire Hospitals NHS Trust  
Refurbishment of NICU/SCBU Ward



The ONVO logo is displayed in a white, bold, sans-serif font in the upper left corner of the image. The background of the entire image is a photograph of a hospital ward, featuring a white sink with a chrome faucet, a purple door with a glass window, and a wall with a hedgehog pattern.

# ONVO

ONVO in Healthcare

Full Height Cliniwash

Client – West Hertfordshire Hospitals NHS Trust  
Refurbishment of NICU/SCBU Ward



# ONVO in Healthcare

Full Height Cliniwash

ONVO

Client – Northampton General NHS Foundation Trust  
New Build | Architect - Catfoss



Full Height Cliniwash

Client – Northampton General NHS Foundation Trust  
New Build | Architect - Catfoss



Recessed Oliniwash

Playroom

Parent Room

Parents Room

Common Room

Common Room

Client – Chelsea & Westminster Hospital NHS Foundation Trust  
Refurbishment of Neptune Ward



Full Height Cliniwash

Client – Chelsea & Westminster Hospital NHS Foundation Trust  
Refurbishment of Neptune Ward

## Full Height Cliniwash



Client – King's College Hospital NHS Foundation Trust  
Refurbishment of the Derek Mitchell Unit | Project Manager - WT Partnership





Client – King's College Hospital NHS Foundation Trust  
 Refurbishment of the Derek Mitchell Unit | Project Manager - WT Partnership



Full Height Cliniwash

Client – South Warwickshire University NHS Foundation Trust  
Cath Labs Refurbishment | Architect - Design Buro

Full Height Cliniwash

Client – South Warwickshire University NHS Foundation Trust  
Cath Labs Refurbishment | Architect - Design Buro





## Full Height Cliniwash



Client – Gateshead Health NHS Foundation Trust  
Refurbishment of Ward 14 | Architect - Anthony Watson Architects

Full Height Cliniwash



Client – Gateshead Health NHS Foundation Trust  
Refurbishment of Ward 14 | Architect - Anthony Watson Architects



## Full Height Cliniwash



Client – York & Scarborough Teaching Hospitals NHS Foundation Trust  
Chestnut Ward

### Full Height Cliniwash



Client – Gateshead Health NHS Foundation Trust  
Care of the Elderly – Ward Refurbishment | Architect - Anthony Watson Architects



Half Height Cliniwash

Client – York & Scarborough Teaching Hospitals NHS Foundation Trust  
Refurbishment of Ward 36 at York Hospital



Half Height Cliniwash



Client – York & Scarborough Teaching Hospitals NHS Foundation Trust  
Refurbishment of Ward 36 at York Hospital



Half Height Cliniwash



Client – The Royal Marsden Hospital

Half Height Cliniwash

Client – The Christie NHS Foundation Trust  
Outpatient Pharmacy | Architect - Gilling Dod Architects



# ONVO in Healthcare

ONVO

Scrubwash

QMC Neonatal  
Intensive Care Unit

Client – Nottingham University Hospitals NHS Trust  
Refurbishment of Neonatal Intensive Care Unit

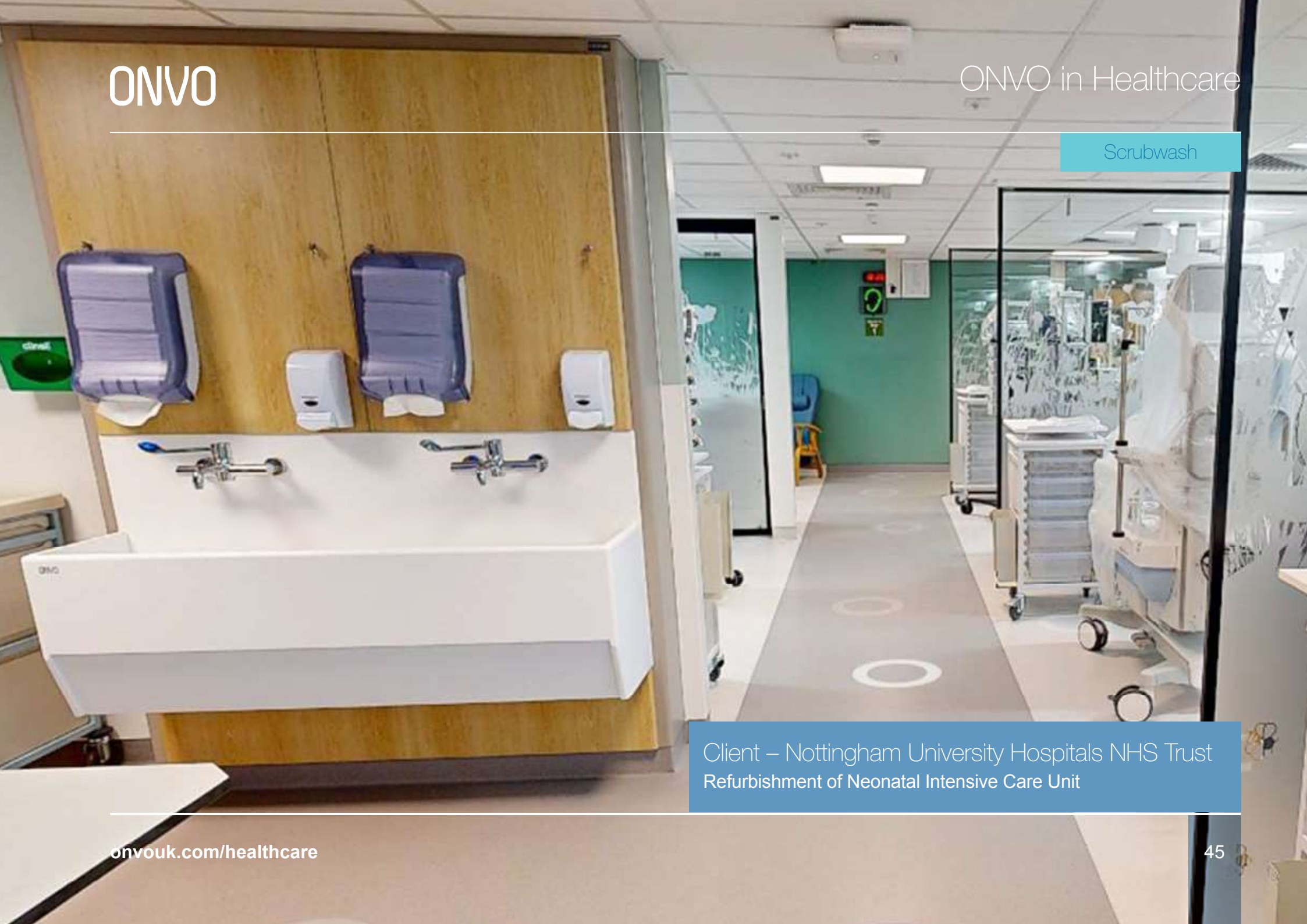

Client – Nottingham University Hospitals NHS Trust  
Refurbishment of Neonatal Intensive Care Unit



# ONVO

**+44 (0)161 302 5342**

**sales@onvouk.com**

---

**ONVO Modular Ltd**

Lexicon House

Third Ave

Poynton Industrial Estate

Poynton

SK12 1YL

United Kingdom

---